



**COPPER BLOOM CONDOMINIUM HOMES**

**“ NEW ELEVATORS FOR COPPER BLOOM ”**

**3-STORY 3-BEDROOM / 2 BATH  
LAKE AND MOUNTAIN VIEWS  
1375 SQUARE FEET ONE LEVEL**

**STANDARDS THAT OTHERS CALL OPTIONS:**

**Elevator with easy access  
In Floor Radiant Heat  
Single Car Garage  
5' Foot Shower  
Vaulted Dormer Ceiling**

**All Appliances- Plus Washer / Dryer  
Master Bedroom 14' X 14'  
Round Drywall Corners  
36" Wide Garden Tub  
Window Blinds**

**AMENITIES**

**Lake and Beach, Mountains and Parks, Walking Trails, Community Center, Walk to Elementary School, Close to Gallatin River Fishing**

**Call Copper Bloom Sales:**

**Craig Del Grande 406-388-3312**

W.I.N. Inc. P.O. Box 10843, Bozeman, MT 59719 Fax 388-3134

[copperbloom@qwest.net](mailto:copperbloom@qwest.net)

[www.craigdelgrande.com](http://www.craigdelgrande.com)

↑  
TO GARAGES  
ELEVATOR THIS SIDE

BRIDGER VIEW

BRIDGER VIEW

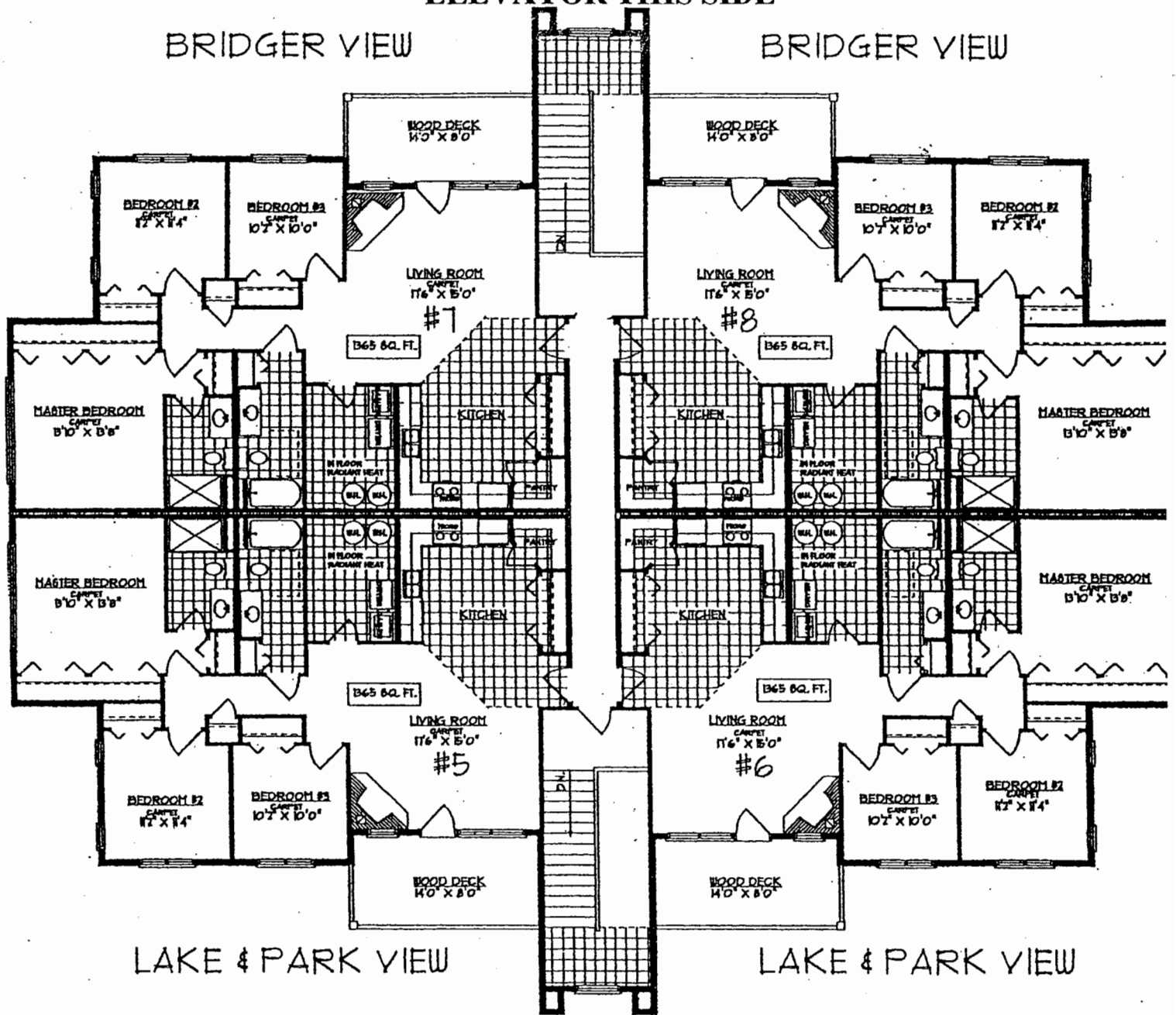

LAKE & PARK VIEW

LAKE & PARK VIEW

**SECOND LEVEL**  
**COPPER BLOOM CONDOMINIUM HOMES**

# COPPER BLOOM

## UPGRADES FOR NEW BUILDINGS 2005

- **3 STORY 12 PLEXES WITH ELEVATORS**
- **ALL UNITS HC ACCESSIBLE WITH FIVE FOOT HALLWAYS**
- **HOT WATER HEATERS REMOVED FROM LAUNDRY ROOM AND PUT IN COMMON MECHANICAL ROOMS IN HALLWAYS**
- **CAST IRON SINKS WITH MOEN PULLOUT SPRAY NOZZLE**
- **ALL BATH VANITIES WILL HAVE 6 DRAWERS**
- **RADIANT FLOOR HEAT WILL HAVE TWO ZONES**
- **ALL BATHROOMS WILL BE INSULATED**
- **FAN/LIGHT COMBO IN ALL BEDROOMS**
- **CAN LIGHTING IN KITCHEN/DINING AREA**
- **CAT 5 PHONE-DATA, CABLE, SATELLITE, DSL, AVAILABLE**
- **TREX DECKING**
- **UNIT 61 IS COMPLETE**
- **UNIT 21 DUE FOR COMPLETION EST. APRIL 2005**
- **UNIT 71 DUE FOR COMPLETION EST. SEPTEMBER 2005**
- **UNIT 111 DUE FOR COMPLETION EST. DECEMBER 2005**

**THANK YOU FOR VIEWING OUR CUSTOM CONDOS !!!!  
IF YOU NEED ADDITIONAL INFO PLEASE CALL .**

**CRAIG DEL GRANDE 406-579-3130  
PRUDENTIAL BRIDGER REALTY**

**COPPER**



**BLOOM**

## **HOME OWNERS DUES AND ASSOCIATED FEES**

INITIAL START UP FEE OF NEW CONDOMINIUMS IS \$300.00

RIVER ROCK PROPERTY ASSOCIATION DUES ARE APPROX. \$200.00 YEAR

RIVER ROCK WATER/SEWER APPROX. \$30.00 A MONTH (depends on usage)

COPPER BLOOM H.O.A. DUES ARE CURRENTLY \$100.00 A MONTH

THEY COVER THE FOLLOWING:

- 24 HOUR MONITORING OF ELEVATOR AND FIRE SUPPRESSION SYSTEM
- BUILDING AND GARAGE INSURANCE
- POWER FOR ALL COMMON AREAS
- WATER FOR ALL COMMON AREAS
- HOUSEHOLD GARBAGE
- CLEANING OF ALL COMMON AREAS
- MISC. MAINTENANCE
- LAWN CARE
- SNOW REMOVAL
- ANY PEST CONTROL
- MISC. OFFICE EXPENSES
- YEARLY ELEVATOR INSPECTIONS AND MAINTENANCE
- OUTSIDE PAINT OR STAIN

THE ABOVE ARE ESTIMATES ONLY FOR THE PURPOSE OF HELPING ANTICIPATE CLOSING COSTS AND MONTHLY OR QUARTERLY PAYMENTS.

NEW 2005

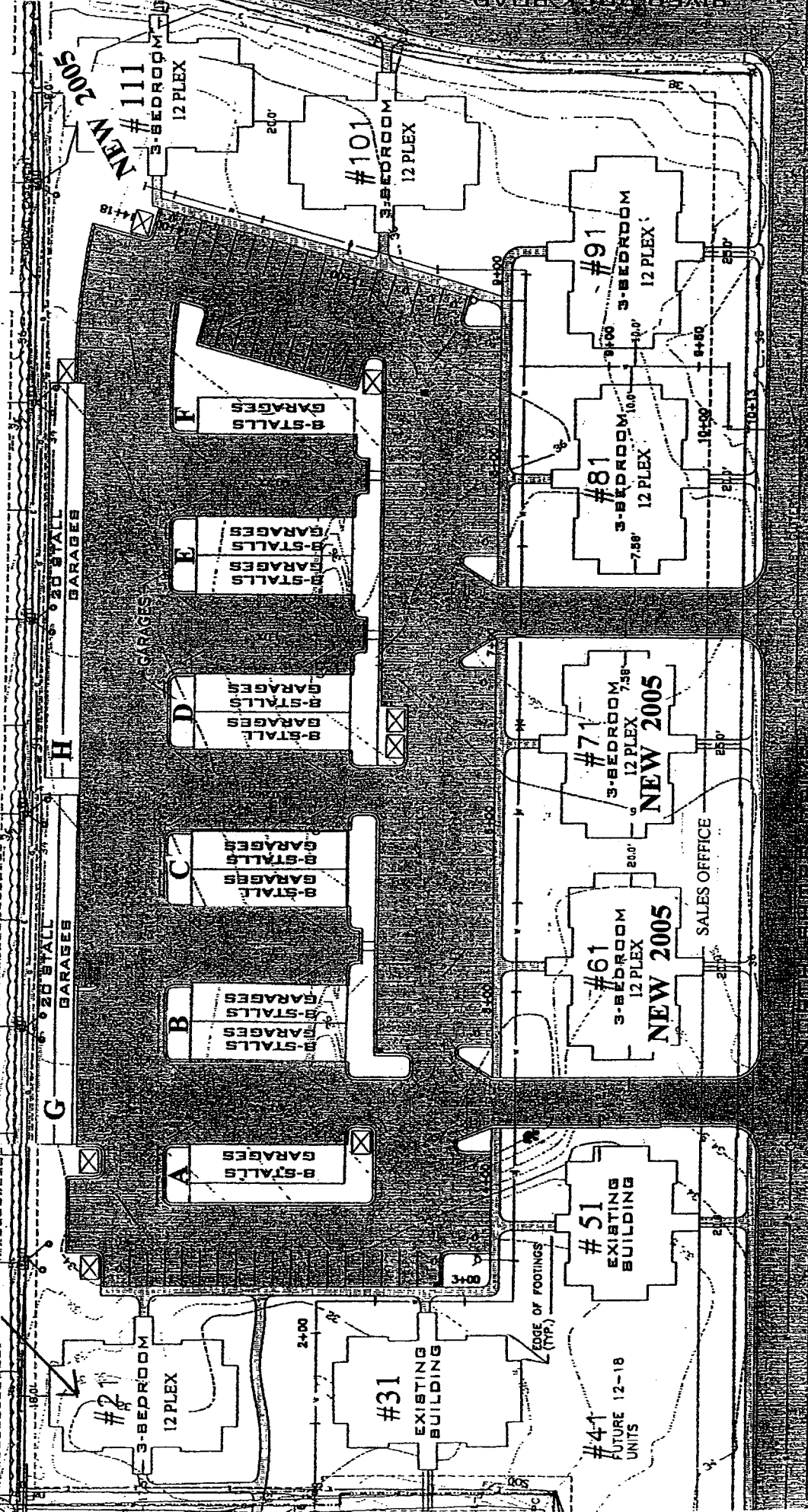

LAKE AND BEACH

**SALES OFFICE IS IN BUILDING 61 # 10**  
**COPPER BLOOM SITE PLAN**

NOT TO SCALE